



HONDA
CB550F

Courtesy of  Honda4Fun
www.hondastour.com www.honda4fun.com

PARTS LIST

© 1977 HONDA MOTOR CO., LTD.

CB550F

CONTENTS

ENGINE GROUP

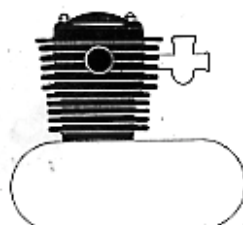

E- 1	Cylinder Head Cover.....	2
E- 2	Cylinder Head.....	6
E- 3	Camshaft - Valve - Tensioner.....	10
E- 4	Cylinder - Piston.....	14

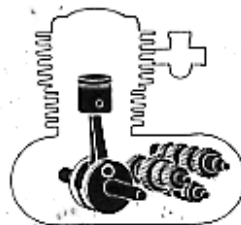

E-12	Crankshaft.....	34
E-13	Primary Shaft - Chain.....	38
E-14	Transmission.....	42
E-15	Shift Drum.....	46



E- 5	Contact Breaker - Advancer.....	16
E- 6	Right Crankcase Cover.....	20
E- 7	Clutch.....	22
E- 8	Generator.....	24
E- 9	Left Crankcase Cover - Starting Motor - Oil Pump.....	26
E-10	Oil Filter - Oil Pan.....	30
E-11	Crankcase.....	32

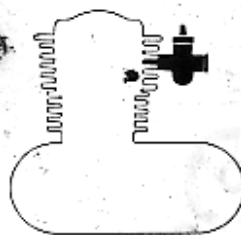

E-16	Carburetor (KEIHIN).....	50
------	--------------------------	----

CONTENTS

FRAME GROUP

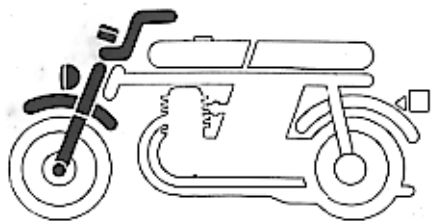

F- 1	Handle Switch - Lever - Cable.....	54
F- 2	Head Light.....	56
F- 3	Speed & Tachometers - Pilot Lamp - Key.....	60
F- 4	Steering Handle - Top Bridge - Stem.....	64
F- 5	Master Cylinder - Brake Hose.....	68
F- 6	Front Fender.....	70
F- 7	Front Shock Absorber.....	72

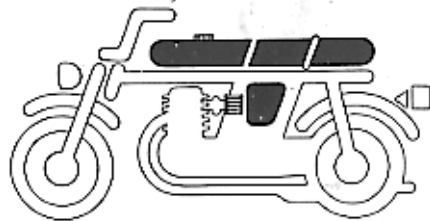

F-12	Fuel Tank.....	90
F-13	Seat - Tool.....	92
F-14	Side Cover - Battery - Regulator.....	96
F-15	Air Cleaner.....	100

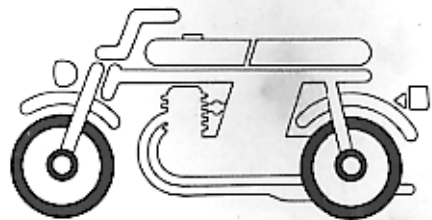

F- 8	Front Brake Caliper.....	76
F- 9	Front Wheel - Disk.....	80
F-10	Rear Brake Panel.....	84
F-11	Rear Wheel.....	86

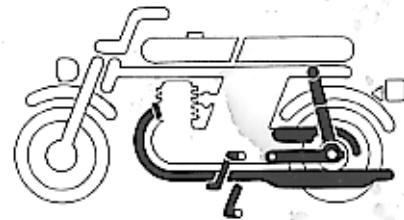

F-16	Exhaust Muffler.....	104
F-17	Change & Brake Pedals - Kick Starter Arm.....	106
F-18	Step - Stand.....	108
F-19	Rear Fork - Chain.....	112
F-20	Rear Shock Absorber.....	114

CONTENTS

FRAME GROUP

INDEX

Part Number Index..... (1)

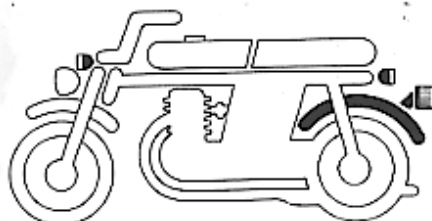

F-21	Rear Fender.....	116
F-22	Turn Signal Light.....	118
F-23	Tail Light.....	122



F-24	Wire Harness · Ignition Coil · Horn.....	124
F-25	Frame Body.....	128

INSTRUCTIONS FOR THE USE OF THIS PARTS LIST

This parts list is to be used when ordering spare parts; it contains all parts for model CB550F.

This parts list is a courtesy of Honda4Fun
(www.honda4fun.co - www.honda4fun.com)

I. How To Order Parts

1. Information required

Spare parts orders must contain both the part number and the stamped number(s) as described below. This is because any changes and modifications of parts are registered at HONDA with the pertinent parts and stamped numbers.

Numbers needed:

- (a) Carburetor parts: Part number &
Stamped carburetor identification number
- (b) Engine parts: Part number &
Stamped engine number
- (c) Frame parts: Part number &
Stamped frame number

2. Revisions

When modifications or additions to this parts list are made, a revised edition will be issued at an appropriate time, with successively progressing revision numbers on the cover. We advise to obtain such revisions in order to keep your parts lists up-to-date at all times. To check whether a parts list revision has been issued, please contact your HONDA distributor.

II. How To Read This Parts List

1. Make-up of the part number

(Example) General parts

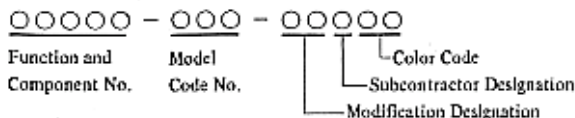

(Example) Bolts, nuts and other standard parts

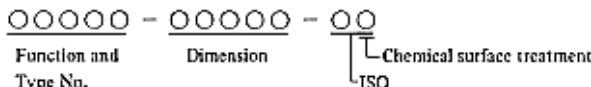

2. Color code

The color code at the end of the part number indicates the color. Codes below ZA in alphabetical order (such as ZA, ZB, ZC, etc.) do not indicate the color directly, but reference must be made to the HONDA code given in the "Description" column of this parts list.

Color code		Color Description
Parts code	HONDA code	
A		White
B		Black
XW		Chrome Plated
ZA	A-01	Semi Glazed Black
ZA	NH-1	Black
ZA	PB-3C-C	Candy Sapphire Blue
ZB	R-2C-F	Flake Sunrise Orange

3. Abbreviations

The following abbreviations are used in this parts list.

ASSY.	Assembly
COMP.	Complete
HEX.	Hexagonal
22T.	22 teeth

4. Dimensions

All dimensions are given in millimeters (mm) except in the case of steel balls, tires and tire tubes.

Parts	Example	Interpretation
Bolt (Screw)	6x12	6 mm diameter, 12 mm length
Pin	8x14	8 mm diameter, 14 mm length
O-Ring	9.5x1.6	9.5 mm diameter, 1.6 mm thickness
Oil seal	14x24x5	14 mm inside diameter, 24 mm outside diameter, 5 mm thickness
Tube	5x130	5 mm inside diameter, 130 mm length

5. Superseding of parts

Part numbers given under the part name in the "Description" column indicate that the part number has been superseded by that part number. HONDA may make such superseding without notice.

6. Assemblies

Sections framed with broken lines in the exploded view drawings are available as complete assemblies. (Their individual parts can also be obtained.)

7. Required quantity

The number given in the "Reqd. No." column indicates the quantity of parts used in the section described in that block.

8. Part Modifications — Applicable Serial Numbers

In cases where a part has been modified, the serial number of the first vehicle (or frame, engine, carburetor, final drive) bearing the modification is listed in the "Serial No." column.

9. Models, Area Codes and Initial Serial No's.

Models, Area Codes and Initial Serial No's. given in this parts list can be identified as follows.

Model/Area code	Type	Initial Serial Engine No.	Initial Serial Frame No.	Initial Serial Carburetor No.
CH550F-A	U. S. A.	CH450FE-1000091-	CH550F-1000001-	069 <u>A</u>

* Of carburetor serial numbers, only the portions underlined in the example below are used for registration.

069

A

A

KC 7



10. Location of stamped serial number

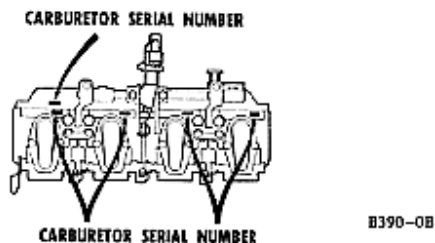
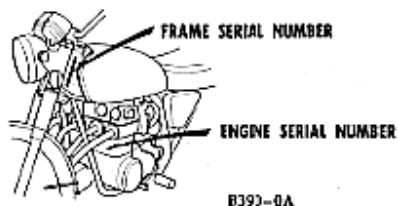

February 1, 1975
HONDA MOTOR CO., LTD.

E-1 Cylinder Head Cover

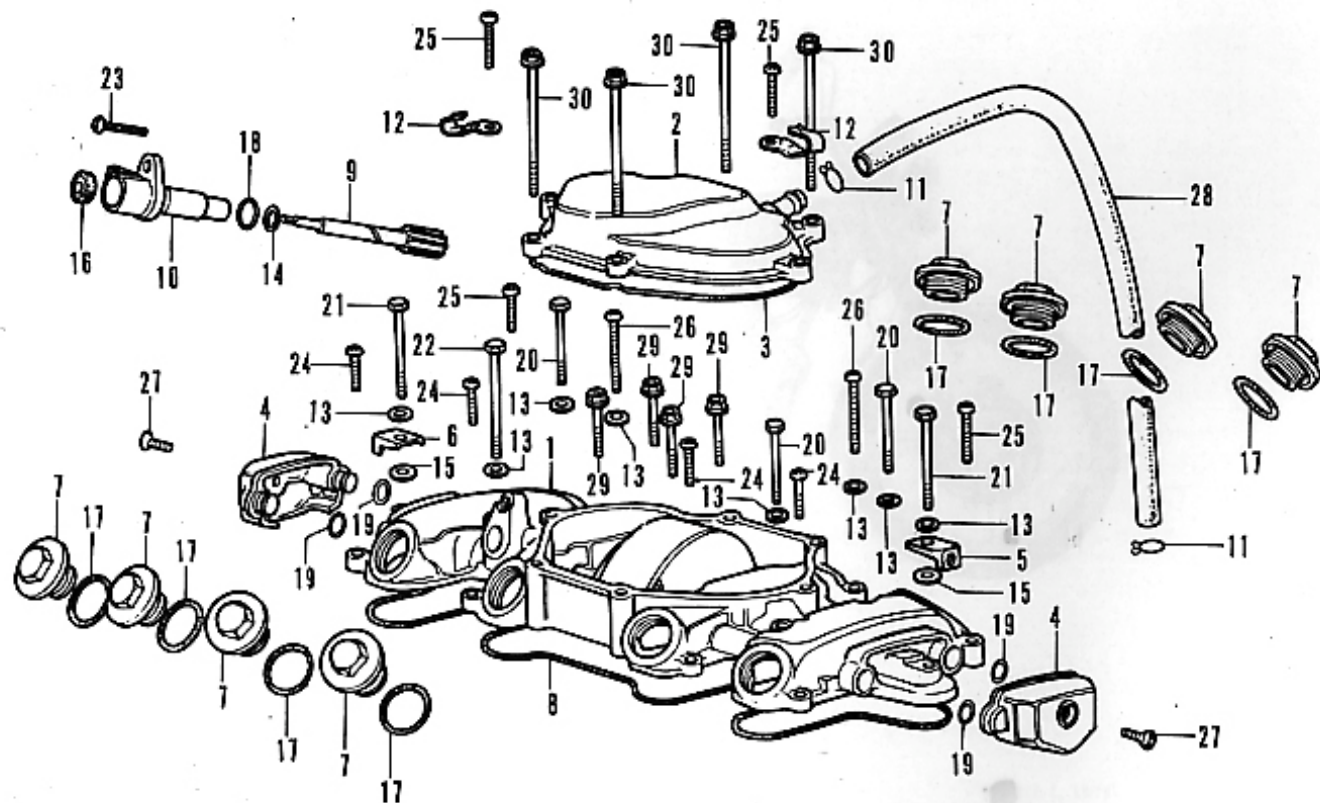

B390-1

E-1 Cylinder Head Cover

Ref. No.	Part No.	Description	Reqd. No. CB550F	Serial No.	Area code
1	12310-323-000	COVER, CYLINDER HEAD	1		
2	12320-374-000	COVER COMP., BREATHER	1		
3	12329-323-000	GASKET, BREATHER COVER	1		
4	12330-323-000	COVER, CYLINDER HEAD SIDE	2		
5	12335-323-000	PLATE A, CYLINDER HEAD SIDE COVER SETTING	1		
6	12336-323-000	PLATE B, CYLINDER HEAD SIDE COVER SETTING	1		
7	12361-300-000	CAP, TAPPET ADJUSTING HOLE	8		
8	12391-323-000	GASKET, CYLINDER HEAD COVER	1		
9	12431-323-000	GEAR, TACHOMETER	1		
10	12451-323-000	CAP, TACHOMETER	1		
11	15772-551-000	CLIP, BREATHER TUBE	2		
12	32906-028-000	CLIP, HIGH TENSION CORD	2		
13	90425-300-000	WASHER, 11MM	8		
14	90451-292-000	WASHER, THRUST, 7MM	1		
15	90485-001-000	WASHER, 6.5MM	2		
16	91211-286-003	OIL SEAL, 4.8X14.5X4	1		
17	91302-001-020	O-RING, 30.8MM	8		
18	91309-035-000	O-RING, 11X2.5	1		
19	91319-323-000	O-RING, 6X3	4		
20	92000-06040	BOLT, HEX., 6X40	3		



E-1 Cylinder Head Cover

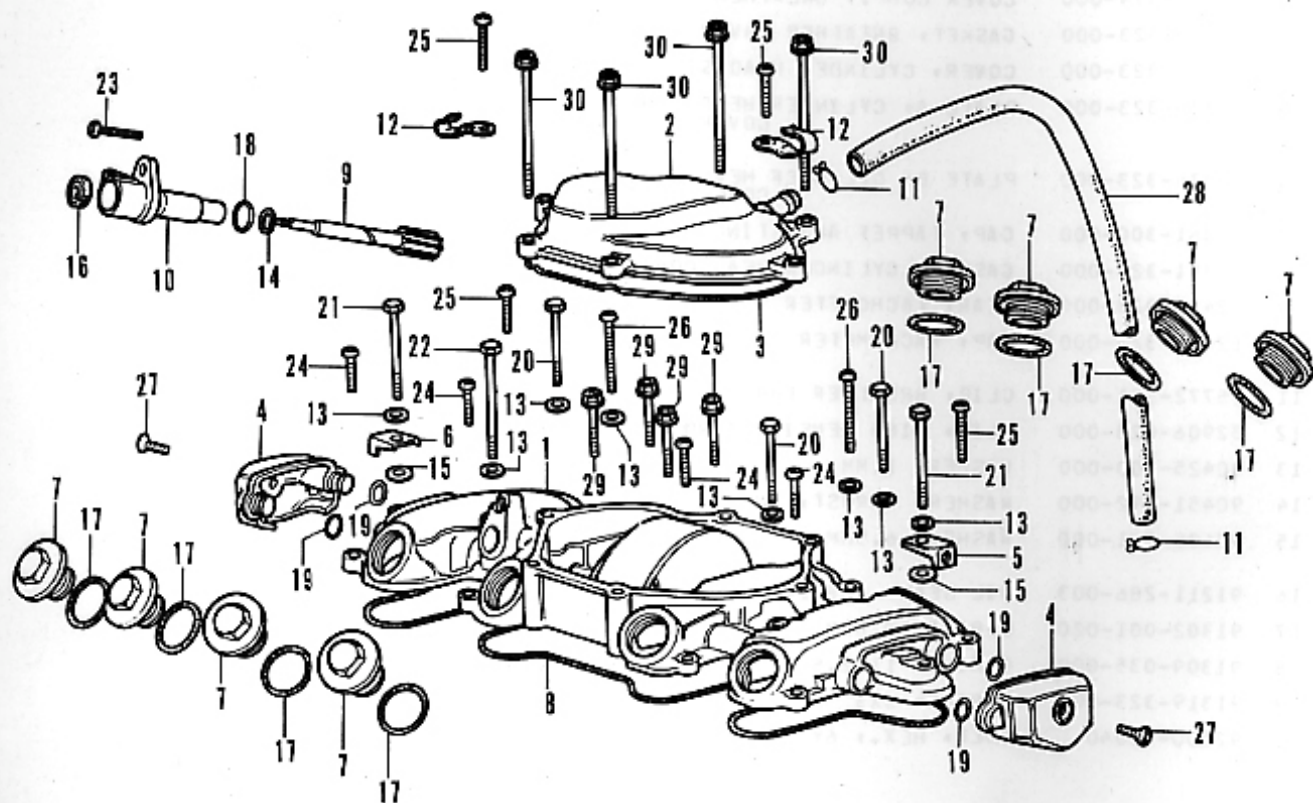

B390-1

E-1 Cylinder Head Cover

Ref. No.	Part No.	Description	Reqd. No. CB550F	Serial No.	Area code
21	92000-06045	BOLT, HEX., 6X45	2		
22	92000-06050	BOLT, HEX., 6X50	1		
23	93500-06016	SCREW, PAN, 6X16	1		
24	93500-06020	SCREW, PAN, 6X20	4		
25	93500-06025	SCREW, PAN, 6X25	4		
26	93500-06040	SCREW, PAN, 6X40	2		
27	93700-06010-02	SCREW, OVAL, 6X10	2		
28	95005-12420-20	TUBE, 12X420	1		
29	95700-06032	BOLT, FLANGE, 6X32	4		
30	95700-06065	BOLT, FLANGE, 6X65	4		

E-2 Cylinder Head

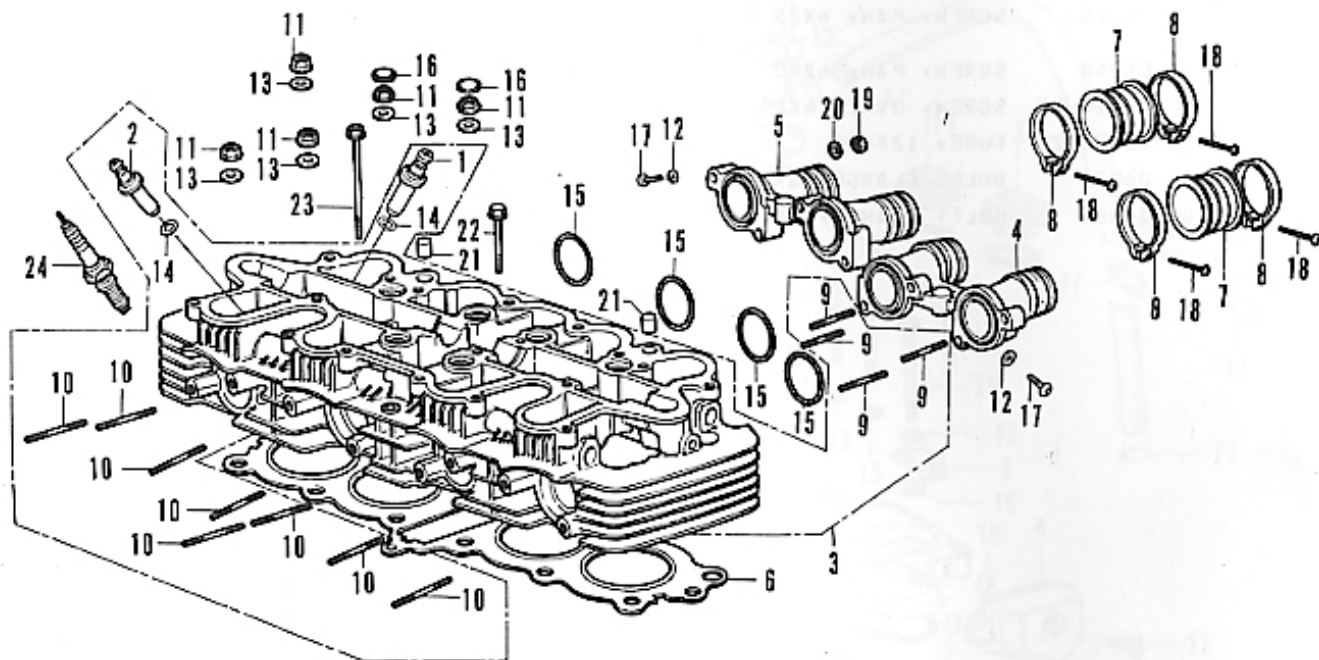

B390-2

E-2 Cylinder Head

Ref. No.	Part No.	Description	Reqd. No. CB550F	Serial No.	Area code
1	12021-323-300	GUIDE, INLET VALVE	4		
2	12023-323-300	GUIDE, EXHAUST VALVE	4		
3	12200-374-000	HEAD COMP., CYLINDER	1		
4	12241-323-000	MANIFOLD A, INLET	1		
5	12242-323-000	MANIFOLD B, INLET	1		
6	12251-374-000	GASKET, CYLINDER HEAD	1		
7	16211-323-000	INSULATOR, CARBURETOR	4		
8	17256-323-000	BAND B, CLEANER CONNECTING TUBE	8		
9	90043-323-300	BOLT, STUD, 6X32	8		
10	90044-323-300	BOLT, STUD, 6X40	8		
11	90236-300-000	NUT, 8MM	12		
12	90452-323-000	WASHER, THRUST, 5MM	4		
13	90485-035-000	WASHER, 14MM	12		
14	91301-200-000	O-RING, 10X1.6	8		
15	91302-001-020	O-RING, 30.8MM	4		
16	91318-300-013	RUBBER, SEALING	6		
17	93500-05006-0A	SCREW, PAN, 5X6	4		
18	93500-05020-0A	SCREW, PAN, 5X20	3		
19	94001-06000	NUT, HEX., 6MM	8		
20	94101-06000	WASHER, PLAIN, 6MM	8		

E-2 Cylinder Head

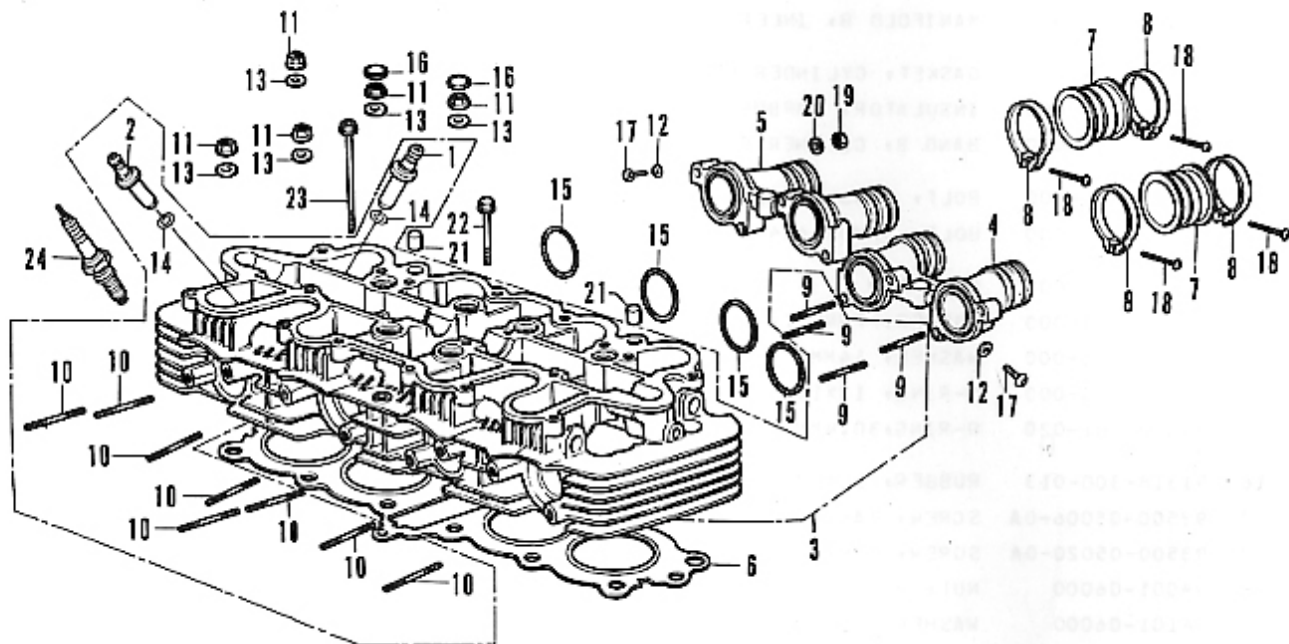

B390-2

E-2 Cylinder Head

Ref. No.	Part No.	Description	Reqd. No. CB550F	Serial No.	Area code
21	94302-10160	PIN, DOWEL, 10X16	2		
22	95700-06032	BOLT, FLANGE, 6X32	1		
23	95700-06065	BOLT, FLANGE, 6X65	1		
24	98069-57711	PLUG, SPARK (D-7ES NGK)	4		
	98069-57723	PLUG, SPARKING (X-22ES ND)	4		



E-3 Camshaft • Valve • Tensioner

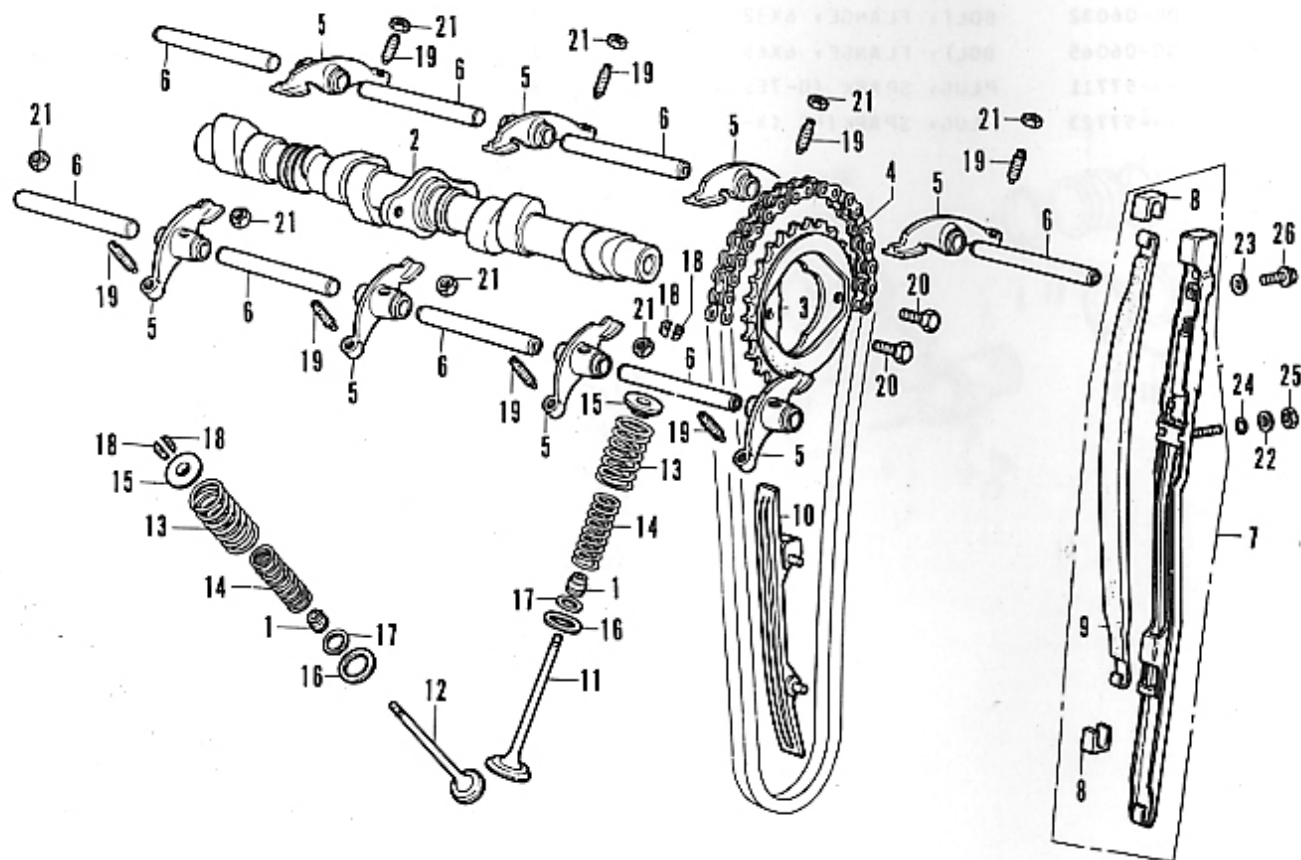

B390-3

E-3 Camshaft • Valve • Tensioner

Ref. No.	Part No.	Description	Reqd. No. CB550F	Serial No.	Area code
1	12209-333-005	SEAL, VALVE STEM	8		
2	14101-323-000	CAMSHAFT	1		
3	14321-323-000	SPROCKET, CAM	1		
4	14401-323-003	CHAIN, CAM	1		
5	14431-324-000	ARM, VALVE ROCKER	8		
6	14451-323-010	SHAFT, VALVE ROCKER ARM	8		
7	14500-323-000	TENSIONER COMP., CAM CHAIN	1		
8	14501-323-000	DAMPER, CAM CHAIN TENSIONER-	2		
9	14520-323-000	SLIPPER, CAM CHAIN TENSIONER	1		
10	14611-323-000	GUIDE, CAM CHAIN	1		
11	14711-107-020	VALVE, INLET	4		
12	14721-323-005	VALVE, EXHAUST (MITSUBISHI)	4		
13	14751-107-010	SPRING, VALVE (OUTER)	8		
14	14761-107-010	SPRING, VALVE (INNER)	8		
15	14771-107-020	RETAINER, VALVE SPRING	8		
16	14775-107-000	SEAT, VALVE SPRING OUTER	8		
17	14776-107-010	SEAT, VALVE SPRING INNER	8		
18	14781-107-020	COTTER, VALVE	16		
19	9C012-300-000	SCREW, TAPPET ADJUSTING	8		
20	9C081-246-000	BOLT, HEX., KNOCK, 7X12	2		

E-3 Camshaft • Valve • Tensioner

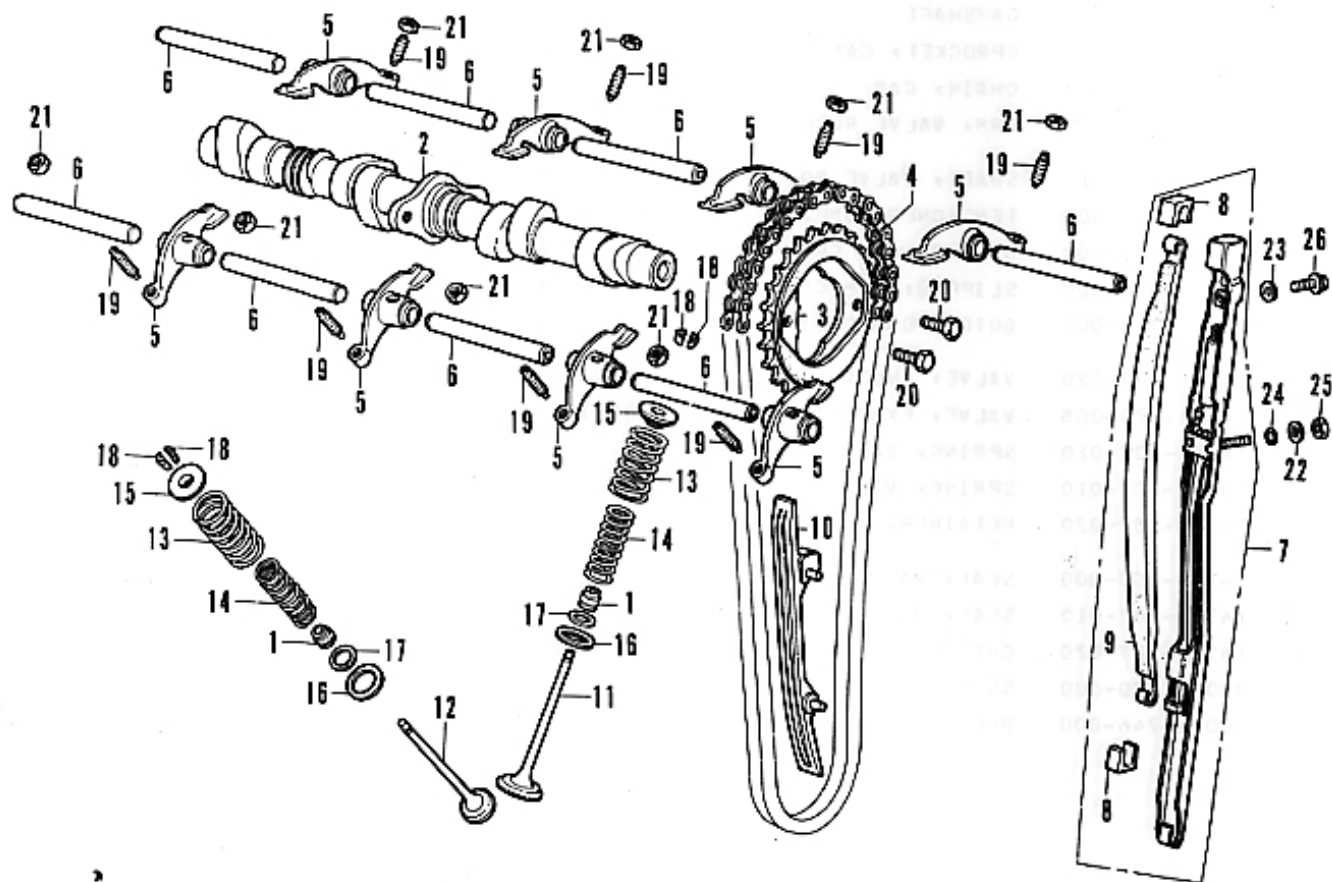

B390-3



E-3 Camshaft • Valve • Tensioner

Ref. No.	Part No.	Description	Reqd. No. CB550F	Serial No.	Area code
21	90206-250-000	NUT, TAPPET ADJUSTING	8		
22	90442-035-000	WASHER, SEALING, 6MM	1		
23	90481-250-000	WASHER A, 6.5MM	1		
24	91305-323-000	O-RING, 5.8X1.9	1		
25	94001-06000	NUT, HEX., 6MM	1		
26	95700-06022	BOLT, FLANGE, 6X22	1		



E-4 Cylinder • Piston

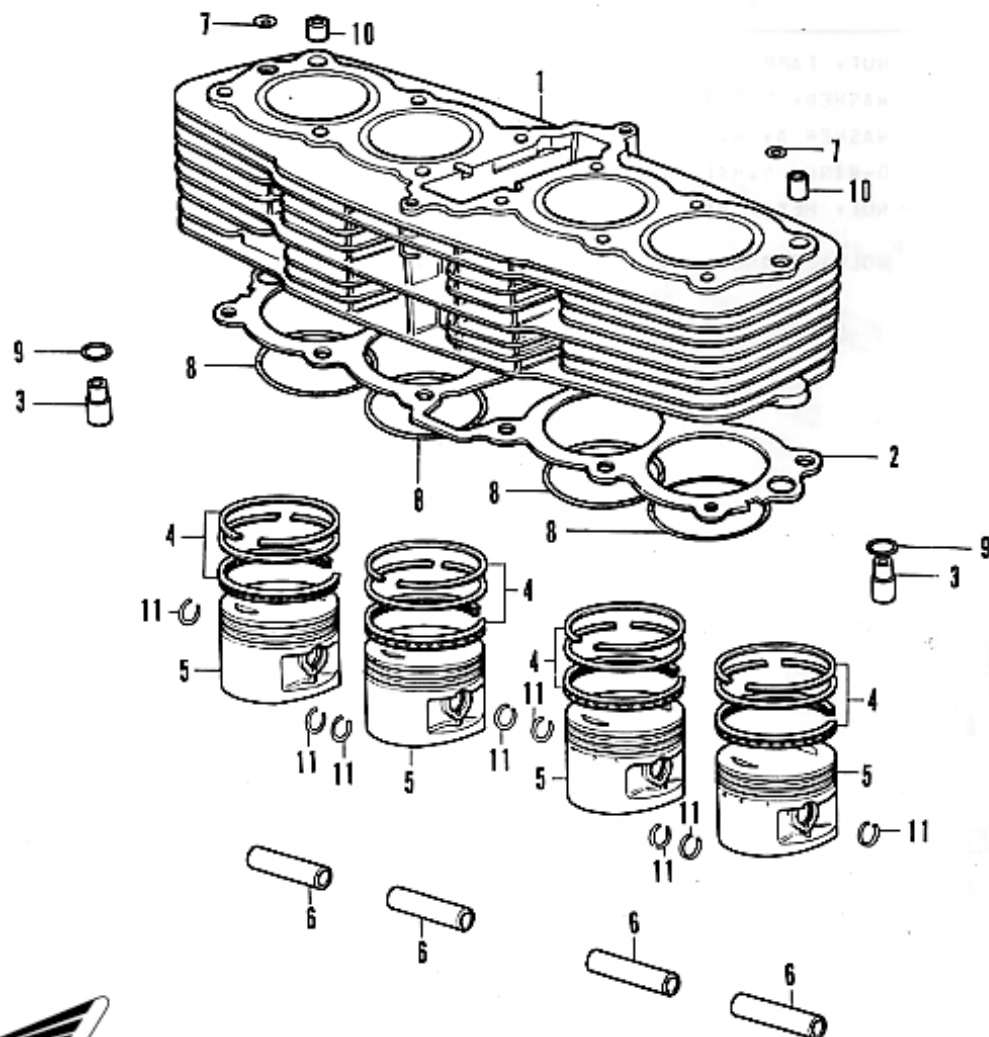

B390-4

E-4 Cylinder • Piston

Ref. No.	Part No.	Description	Reqd. No. CB550F	Serial No.	Area code
1	12100-374-000	CYLINDER COMP.	1		
2	12191-374-000	GASKET, CYLINDER	1		
3	12238-323-000	VALVE, OIL CONTROL	2		
4	13011-374-004	RING SET, PISTON (STD. RIKEN)	4		
	13021-374-000	RING SET, PISTON (0.S.0.25, RIKEN)	4		
	13031-374-000	RING SET, PISTON (0.S.0.50 RIKEN)	4		
	13041-374-000	RING SET, PISTON (0.S.0.75 RIKEN)	4		
	13051-374-000	RING SET, PISTON (0.S.1.00 RIKEN)	4		
5	13101-374-000	PISTON (STD.)	4		
	13102-374-000	PISTON (0.25)	4		
	13103-374-000	PISTON (0.50)	4		
	13104-374-000	PISTON (0.75)	4		
	13105-374-000	PISTON (1.00)	4		
6	13111-286-000	PIN, PISTON	4		
7	91301-323-000	O-RING, 5X2.4	2		
8	91304-286-000	O-RING, 61.8X2.0	4		
9	91309-035-000	O-RING, 11X2.5	2		
10	94301-12180	PIN, KNOCK, 12X18	2		
11	94601-15000	CLIP, PISTON PIN, 15MM	8		

E-5 Contact Breaker • Advancer

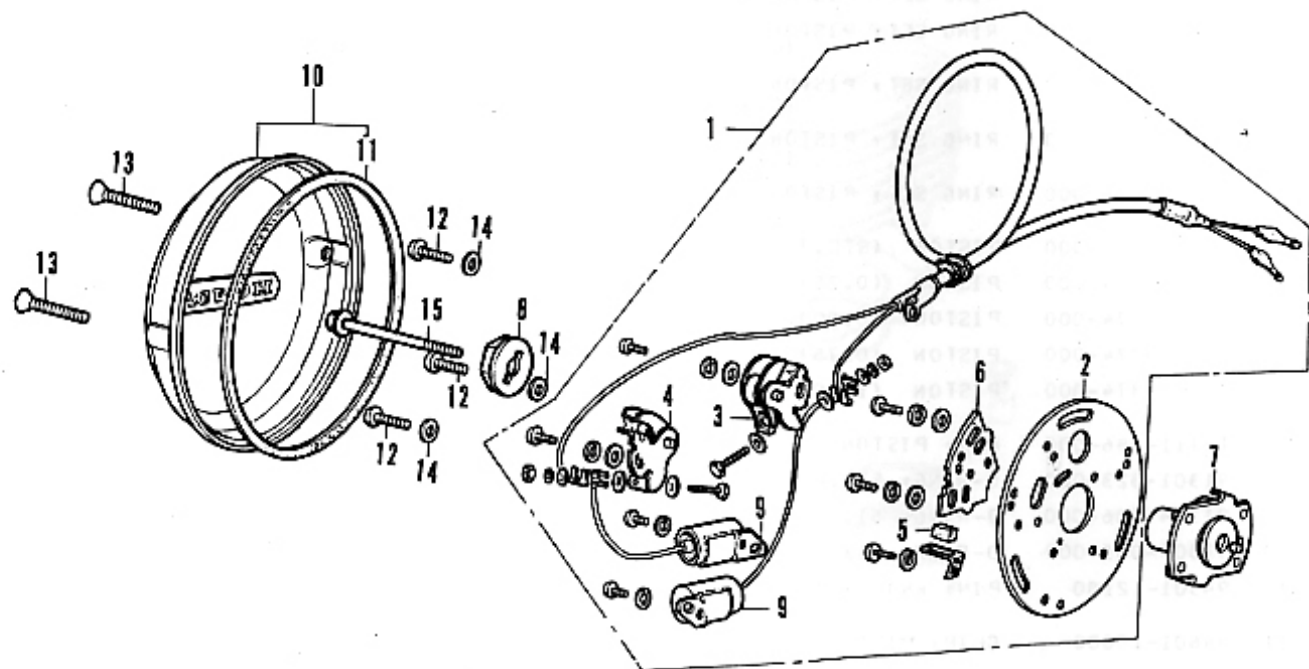

B390-5