

# TAILLIGHT • TURN SIGNAL - K

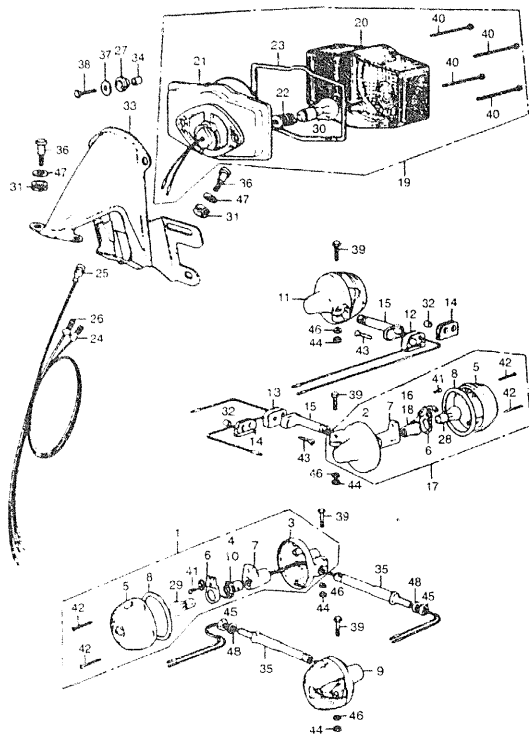

F 10374006

K = CB550  
K1 = CB550K1  
6 = CB550K76

CB550

CB550K

CB550K76

Ref No	BLOCK NO DESCRIPTION	F-B	K	K1	7	6	FRAME SERIAL NUMBER		QTY REQ	PART NUMBER	HONDA CODE
							FROM	TO			
44	NUT, HEX., 6MM		K						4	94001-06000-05	0156067
	NUT, HEX., 6MM		K						4	94001-06008-05	2829414
	NUT, HEX., 6MM		K						4	94001-06200-05	2043255
	NUT, HEX., 6MM		K						4	94030-06000	1642693
45	NUT, HEX., 10MM		K						2	94001-10000-05	0145391
46	WASHER, PLAIN, 6MM		K						4	94101-06000	0059071
	WASHER, PLAIN, 6MM		K						4	94101-06080	3136074
	WASHER, PLAIN, 6MM		K						4	94101-06800	0345900
47	WASHER, PLAIN, 8MM		K						4	94101-08200	0059105
48	WASHER, SPRING, 8MM		K						2	94111-10000	0059006

## CONTENTS

TITLE	PAGE GRID
AIR CLEANER	76 E3
ALTERNATOR	24 E12
BEET	48 C12
BIKAR MASTER FH	132 G6
CABLE	50 D1
CARSHAFT	10 E5
CARBURETOR	44 C10
CLUTCH	74 E6
CRANKCASE	40 C8
CRANKCASE COVER	14 E8
CRANKSHAFT	10 E5
CYLINDER	2 E3
CYLINDER	132 G6
EXHAUST MUFFLER	96 E9
FENDER FR	42 E7
FRAME	118 E11
FUEL TANK	78 E3
HANDLEBAR	60 D5
HEAD	2 E3
HEADLIGHT	16 E4
HIGH-SPANDER SPINDLE	30 C1
OIL FILTER	40 C8
OIL PUMP	24 E12
SHOCK ABSORBER RH	98 E1
SPEEDOMETER	96 D4
STEERING STEM	42 C7
STEP	90 E9
SWINGARM	98 E1
TACHOMETER	56 D4
TAILLIGHT K	106 F5
TAILLIGHT K1-76	112 F8
TRANSMISSION	40 C3
TURN SIGNAL K	106 F5
TURN SIGNAL K1-76	112 F8
WASHER (CRANKCASE)	48 C10
WHEEL FR	70 D11
WHEEL RR	70 D11
WIRE HARNESS	118 F11

100 - AMERICAN HONDA MOTOR CO. LTD. 1984

CB550 ENGINE NO.; CB550E-1000001 TO SUBSEQUENT  
CB550 FRAME NO.; CB550K-1000001 TO SUBSEQUENT  
CB550K1 ENGINE NO.; CB550E-1029182 TO SUBSEQUENT  
CB550K1 FRAME NO.; CB550K-1200001 TO SUBSEQUENT

CB550K76 ENGINE NO.; CB550E-1067334 TO SUBSEQUENT  
CB550K76 FRAME NO.; CB550K-1230001 TO SUBSEQUENT

1 - AMERICAN HONDA MOTOR CO. LTD. 1984 111

(GHI)

F7

# TAILLIGHT • TURN SIGNAL - K-1-76

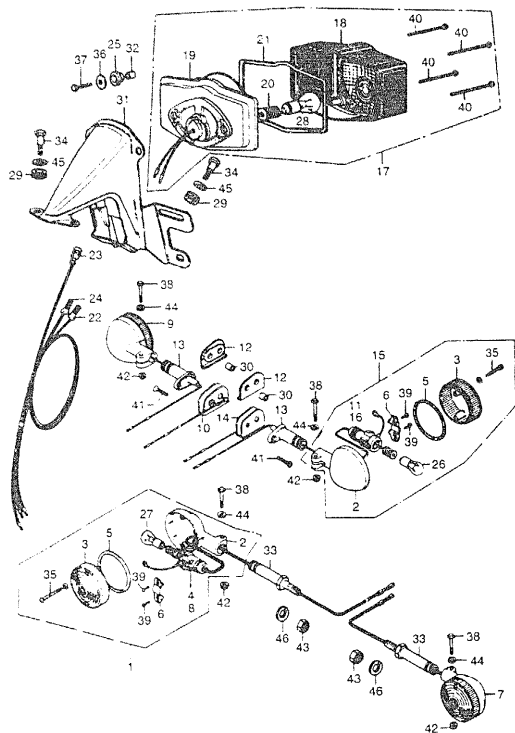

F1337400603

AMERICAN HONDA MOTOR CO., LTD. 1984

CB550 ENGINE NO.; CB550E-1000001 TO SUBSEQUENT  
CB550 FRAME NO.; CB550K-1000001 TO SUBSEQUENT  
CB550K1 ENGINE NO.; CB550E-1029182 TO SUBSEQUENT  
CB550K1 FRAME NO.; CB550K-1200001 TO SUBSEQUENT

CB550K176 ENGINE NO.; CB550E-1067334 TO SUBSEQUENT  
CB550K176 FRAME NO.; CB550K-1230001 TO SUBSEQUENT

		K = CB550 K1 = CB550K1 6 = CB550K176		CB550		CB550K		FRAME SERIAL NUMBER		QTY			
Ref No	BLOCK NO DESCRIPTION	F-8-1	K	K1	6	K	K1	FROM	TO	REQ	PART NUMBER	HONDA CODE	
1	TURN SIGNAL ASSY., R. FR. ....	--	K1	6						1	33400-377-671	0386334	
	TURN SIGNAL ASSY., R. FR. ....	--	K1	6						1	33400-461-670	0918516	
	TURN SIGNAL ASSY., R. FR. ....	--	K1	6						1	33400-461-679	2079218	
2	BASE, R. FR. TURN SIGNAL .....	--	K1	6						4	33401-377-671	0386342	
3	LENS, FR. TURN SIGNAL .....	--	K1	6						4	33402-377-671	0386359	
4	SOCKET COMP., R. FR. TURN SIGNAL ..	--	K1	6						1	33405-377-671	0386367	
5	GASKET, TURN SIGNAL LENS .....	--	K1	6						4	33406-377-671	0387944	
6	HOLDER, FR. TURN SIGNAL SOCKET ...	--	K1	6						4	33407-377-671	0386375	
7	TURN SIGNAL ASSY., R. FR. ....	--	K1	6						1	33400-377-671	0386334	
	TURN SIGNAL ASSY., R. FR. ....	--	K1	6						1	33400-461-670	0918516	
	TURN SIGNAL ASSY., R. FR. ....	--	K1	6						1	33400-461-679	2079218	
	TURN SIGNAL ASSY., L. FR. ....	--	K1	6						1	33450-377-671	0386383	
8	SOCKET COMP., L. FR. TURN SIGNAL ..	--	K1	6						1	33455-377-671	0386391	
9	TURN SIGNAL, R. RR. ....	--	K1	6						1	33600-374-671	0387662	
10	STOPPER, R. RR. TURN SIGNAL .....	--	K1	6						1	33604-374-670	0387670	
11	SOCKET COMP., R. RR. TURN SIGNAL ..	--	K1	6						1	33605-374-671	0387688	
	SOCKET COMP., R. RR. TURN SIGNAL ..	--	K1	6						1	33610-374-671	0699447	
12	RUBBER, RR. TURN SIGNAL SETTING ..	--	K1	6						2	33606-374-670	0387696	
13	STAY, R. RR. TURN SIGNAL .....	--	K1	6						2	33607-374-670	0387704	
14	STOPPER, L. RR. TURN SIGNAL .....	--	K1	6						1	33609-374-670	0387712	
15	TURN SIGNAL ASSY., L. RR. ....	--	K1	6						1	33650-374-671	0387720	
16	SOCKET COMP., L. RR. TURN SIGNAL ..	--	K1	6						1	33655-374-671	0387738	
	SOCKET COMP., L. RR. TURN SIGNAL ..	--	K1	6						1	33660-374-671	0746461	
17	TAILLIGHT UNIT .....	--	K1	--						1	33701-341-671	0268755	
	TAILLIGHT UNIT (12V 32/3CP) .....	--	6							1	33701-341-910	0435156	
18	LENS, TAILLIGHT .....	--	K1	6						1	33702-341-671	0268680	
19	BASE COMP., TAILLIGHT .....	--	K1	--						1	33703-341-671	0268698	
	BASE COMP., TAILLIGHT .....	--	6							1	33703-341-900	0435164	
20	CABLE COMP., TAILLIGHT .....	--	K1	6						1	33708-341-671	0268706	
21	GASKET, TAILLIGHT LENS .....	--	K1	6						1	33709-341-671	0268714	
22	CABLE, TAILLIGHT SUB .....	--	K1	6						1	33711-323-000	0312645	
23	CABLE, TAILLIGHT GROUND (STANLEY)	--	K1	6						1	33712-300-003	0192013	

AMERICAN HONDA MOTOR CO., LTD. 1984 113

## CONTENTS

TITLE	PAGE	GRID
AIR CLEANER	76	E3
ALTERNATOR	24	B12
BOLT	46	C12
BRAKE MASTER FH	132	G6
CABLE	50	D1
CAMSHAFT	10	B5
CARBURETOR	44	C10
CLUTCH	16	B8
CRANKCASE	40	C8
CRANKCASE COVER	14	B9
CRANKSHAFT	10	B5
CYLINDER	2	B1
CYLINDER	100	G6
EXHAUST MUFFLER	90	E9
FENDER FR	65	D7
FRAME	116	F11
FUEL TANK	76	E3
HANDLEBAR	50	D1
HEAD	2	B1
HEADLIGHT	56	D4
KICK STARTER SPINDLE	50	C2
OIL FILTER	40	C8
OIL PUMP	24	B12
SHOCK ABSORBER RR	96	F1
SPEEDOMETER	56	D4
STEERING STEM	62	D7
STEP	90	E9
SWINGARM	98	F1
TACHOMETER	96	D4
TAILLIGHT K	106	F5
TAILLIGHT K1-76	112	F8
TRANSMISSION	20	C3
TURN SIGNAL K	106	F5
TURN SIGNAL K1-76	112	F8
WASHER (CRANKCASE)	48	C12
WHEEL FR	70	D11
WHEEL RR	70	D11
WIRE HARNESS	118	F11

GRID

F8

# TAILLIGHT • TURN SIGNAL - K-176

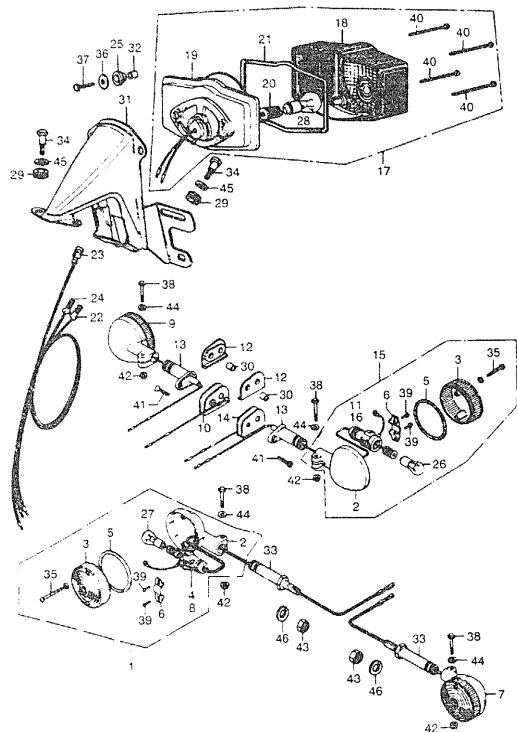

F1337400801

K = CB550  
K1 = CB550K1  
6 = CB550K76

Ref No	BLOCK NO. DESCRIPTION	F-81	K 1 6			SERIAL NUMBER FROM TO	R E Q	PART NUMBER	HONDA CODE
			K	K1	6				
24	CABLE, STOPLIGHT SUB .....	--	K1	6	---	---	1	33713-323-000	0312652
25	GASKET B, TAILLIGHT BASE .....	--	K1	---	---	---	2	33719-077-671	0178681
	RUBBER, REGULATOR CUSHION .....	--	6	---	---	---	2	31403-300-000	0191825
	RUBBER, REGULATOR CUSHION .....	--	6	---	---	---	2	31403-323-000	0254300
26	BULB, TURN SIGNAL (12V 23W) .....	--	K1	6	---	---	2	34905-268-671	0145318
27	BULB, 12V23/7W 1034 .....	--	K1	6	---	---	2	34901-504-003	0504530
	BULB, STOP & TAILLIGHT (12V23/8W) .....	--	K1	6	---	---	2	34906-313-671	0210815
28	BULB, TAILLIGHT (12V27/7W 2057HD) .....	--	K1	6	---	---	1	34906-M69-771	1700301
	BULB, TAILLIGHT (12V 27/8W) .....	--	K1	6	---	---	1	34906-341-671	0273540
29	RUBBER, RR. FENDER CUSHION .....	--	K1	6	---	---	4	80101-283-000	0077271
30	COLLAR A, RR. FENDER .....	--	K1	6	---	---	2	80108-061-010	0186643
31	BRACKET, NUMBER PLATE .....	--	K1	6	---	---	1	84701-341-670XW	0291963
32	COLLAR, LICENSE PLATE BRACKET ...	--	K1	---	---	---	2	84706-341-000	0273987
	COLLAR, TAILLIGHT UNIT .....	--	6	---	---	---	2	84706-378-000	0356626
33	BOLT, FR. TURN SIGNAL MOUNT .....	--	K1	6	---	---	2	90154-374-670	0387878
34	BOLT, TAILLIGHT SETTINGS .....	--	K1	6	---	---	4	90162-283-000	0078782
	BOLT, FR. FENDER SETTING .....	--	K1	6	---	---	4	90162-292-000	0212829
35	SCREW, PAN, 4X25 .....	--	K1	6	---	---	8	90192-377-671	0386946
36	WASHER, 20MM .....	--	K1	6	---	---	2	90581-310-000	0113092
37	BOLT, HEX., 5X20 .....	--	K1	---	---	---	2	92000-05020-0B	0192955
	BOLT, HEX., 5X25 .....	--	6	---	---	---	2	92000-05025-0A	0207852
	BOLT, HEX., 5X25 .....	--	6	---	---	---	2	92101-05025-0A	2756260
38	BOLT, HEX., 6X35 .....	--	K1	6	---	---	4	93000-06035-0B	0412270
	BOLT, HEX., 6X35 .....	--	K1	6	---	---	4	93000-06035-02	0387894
	BOLT, HEX., 6X35 .....	--	K1	6	---	---	4	93101-06035-0B	4545653
39	SCREW, PAN, 3X6 .....	--	K1	---	1215784	---	8	93500-03006-0A	0166652
	SCREW, PAN, 3X8 .....	--	6	---	---	---	8	93500-03008-0H	0374694
		--	K1	---	1215785	---	8	93500-03008-0H	0374694
40	SCREW, PAN, 4X55 .....	--	K1	6	---	---	4	93500-04055-4J	0274084
41	SCREW, OVAL, 6X25 .....	--	K1	6	---	---	2	93700-06025-0B	0420521
	SCREW, 6X25 .....	--	K1	6	---	---	2	93700-06025-02	0056564
42	NUT, HEX., 6MM .....	--	K1	---	---	---	4	90310-K13-711	1553916
	NUT, HEX., 6MM .....	--	K1	---	---	---	4	94000-06000-05	1391283

## CONTENTS

TITLE	PAGE GRID
AIR CLEANER	76 E3
ALTERNATOR	24 B12
BOLT	48 C12
BRAKE MASTER FR	130 G6
CABLE	59 D1
CAMSHAFT	10 B6
CARBURETOR	44 C10
CLUTCH	16 D9
CRANKCASE	40 C8
CRANKCASE COVER	16 B6
CRANKSHAFT	10 B3
CYLINDER	2 B1
CYLINDER	132 G6
EXHAUST MUFFLER	80 E9
FENDER FR	62 D7
FRAME	118 F11
FUEL TANK	76 E3
HANDLEBAR	50 D1
HEAD	2 B1
HEADLIGHT	56 D4
KICK STARTER SPINDLE	20 C3
OIL FILTER	40 C8
OIL PUMP	24 B12
SHOCK ABSORBER FR	96 F1
SPEEDOMETER	56 D4
STEERING STEM	62 D7
STEP	90 E9
SWINGARM	96 F1
TACHOMETER	56 D4
TAILLIGHT K	106 F5
TAILLIGHT K1-76	112 F8
TRANSMISSION	30 C3
TURN SIGNAL K	106 F5
TURN SIGNAL K1-76	112 F8
WASHER (CRANKCASE)	48 C12
WHEEL FR	70 D11
WHEEL RR	70 D11
WIRE HARNESS	118 F11

GRID

F9

114 AMERICAN HONDA MOTOR CO. LTD. 1994

CB550 ENGINE NO.; CB550E-1000001 TO SUBSEQUENT  
CB550 FRAME NO.; CB550K-1000001 TO SUBSEQUENT  
CB550K1 ENGINE NO.; CB550E-1029182 TO SUBSEQUENT  
CB550K1 FRAME NO.; CB550K-1200001 TO SUBSEQUENT

CB550K176 ENGINE NO.; CB550E-1067334 TO SUBSEQUENT  
CB550K176 FRAME NO.; CB550K-1230001 TO SUBSEQUENT

F9

AMERICAN HONDA MOTOR CO. LTD. 1994 115

K = CB550  
K1 = CB550K1  
6 = CB550K'76



E10

K = CB550  
K1 = CB550K1  
6 = CB550K'76

Part No.	DESCRIPTION	BLOCK NO. F-8-1			SERIAL NUMBER		RE Q	PART NUMBER	HONDA CODE
		K	K 1	6	FROM	TO			
42	NUT, HEX., 6MM .....	--	K1	--	-----	-----	4	94001-06000	0058016
	NUT, HEX., 6MM .....	--	K1	--	-----	-----	4	94001-06000-0S	0156067
	NUT, HEX., 6MM .....	--	K1	--	-----	-----	4	94001-06008-0S	2829414
	NUT, HEX., 6MM .....	--	K1	--	-----	-----	4	94001-06200-0S	2043255
	NUT, HEX., 6MM .....	--	K1	--	-----	-----	4	94030-06000	1642693
	NUT, FLANGE, 6MM .....	--	--	6	-----	-----	4	18362-720 L	0293084
	NUT, FLANGE, 6MM .....	--	--	6	-----	-----	4	94050-06000	0471623
43	NUT, HEX., 12MM .....	--	K1	6	-----	-----	2	94001-12000-0S	0169508
44	WASHER, PLAIN, 6MM .....	--	K1	--	-----	-----	4	94101-06000	0059071
	WASHER, PLAIN, 6MM .....	--	K1	--	-----	-----	4	94101-06080	3136074
	WASHER, PLAIN, 6MM .....	--	K1	--	-----	-----	4	94101-06800	0345900
45	WASHER, PLAIN, 8MM .....	--	K1	6	-----	-----	4	94101-08200	0059105
46	WASHER, SPRING, 12MM .....	--	K1	6	-----	-----	2	94111-12000	0059022

© AMERICAN HONDA MOTOR CO., LTD. 1994 117

TITLE	PAGE	GR
AIR CLEANER	78	E3
ALTERNATOR	24	B12
BOLT	44	C11; C12
BRAKE MASTER F1	132	C6
CABLE	50	D1
CAMSHAFT	10	B5
CARBURETOR	44	C11; C12
CLUTCH	16	B8
CRANKCASE	40	C8
CRANKCASE COVER	16	B8
CRANKSHAFT	10	B5
CRANKSHAFT COVER	2	B1
CYLINDER	132	C6
EXHAUST MUFFLER	90	E9
FENDER F1	62	D7
F1 FRAME	11	F1; F2
FUEL TANK	78	E3
HANDLEBAR	50	D1
HEAD	2	B1
HEADLIGHT	55	D4
KICK STARTER SPINDLE	30	C3
Oil FILTER	40	C8
OIL PUMP	24	B12
SPARK ARRESTOR, R1	98	F7
SPEEDOMETER	54	D4
STEERING STEM	62	D7
STEP	90	E9
SWINGARM	98	F7
TACHOMETER	44	C11; C12
TAILLIGHT K	106	F5
TAILLIGHT K1-76	112	B8
TRANSMISSION	3	C3
TURN SIGNAL K	112	B8
TURN SIGNAL K1-76	112	B8
WASHER (CRANKCASE)	48	C8
WHEEL F1	70	D1
WHEEL R1	70	D1
WIRE HARNESS	118	F1

GRID

F10

# FRAME • WIRE HARNESS

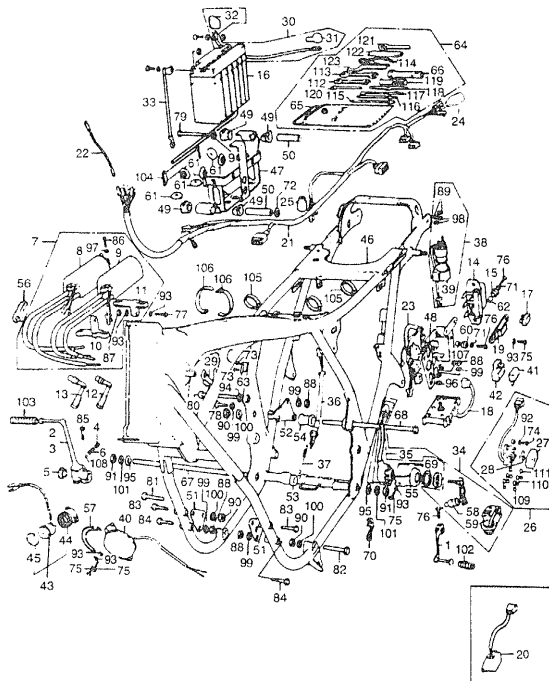

\*CAUTION OR WARNING LABELS MUST BE ORDERED SEPARATELY WHEN APPLICABLE\*

F13374009

118 AMERICAN HONDA MOTOR CO., LTD. 1984

CB550 ENGINE NO.; CB550E-1000001 TO SUBSEQUENT  
CB550 FRAME NO.; CB550K-1000001 TO SUBSEQUENT  
CB550K1 ENGINE NO.; CB550C-1029182 TO SUBSEQUENT  
CB550K1 FRAME NO.; CB550K-1200001 TO SUBSEQUENT

CB550K176 ENGINE NO.; CB550E-1067334 TO SUBSEQUENT  
CB550K176 FRAME NO.; CB550K-1230001 TO SUBSEQUENT

F11

K = CB550  
K1 = CB550K1  
6 = CB550K176

Rel. No.	BLOCK NO. DESCRIPTION	F-9	K	K1	6	CB550	K	K1	6	FRAME SERIAL NUMBER	QTY	REQ	PART NUMBER	HONDA CODE
1	PEDAL, GEAR CHANGE		K	K1	6						1		24700-323-010	0254235
2	ARM COMP., KICK STARTER		K							1022428	1		28300-323-010	0254243
	ARM ASSY., KICK STARTER		K							1022428	1		28300-374-000	0434241
			K								1		28300-374-000	0434241
	ARM COMP., KICK STARTER		K							1022428	1		28300-404-670	0468751
			K								1		28300-404-670	0468751
3	ARM ASSY., KICK STARTER			K1	6						1		28300-374-000	0434241
	ARM COMP., KICK STARTER			K1	6						1		28300-404-670	0468751
4	BOLT, KICK ARM		K	K1	6						1		28303-310-010	0113860
5	CAP, KICK ARM		K	K1	6						1		28305-310-000	0113878
6	SPRING, KICK STARTER STOPPER		K	K1	6						1		28333-310-000	0113886
7	COIL ASSY., IGNITION		K	K1	6						1		30500-323-023	0254250
	COIL ASSY., IGNITION		K	K1	6						1		30500-404-000	0468769
8	COIL, R. IGNITION		K	K1	6						1		30501-323-003	0254268
9	COIL, L. IGNITION		K	K1	6						1		30502-323-003	0254276
10	BRACKET, IGNITION COIL		K	K1	6						1		30511-300-000	0192104
11	BRACKET B, IGNITION COIL		K	K1	6						1		30512-323-000	0254284
12	CAP ASSY., NOISE SUPPRESSOR		K	K1	6						2		30700-GAR-000	4192779
	CAP ASSY. A, NOISE SUPPRESSOR		K	K1	6						2		30700-300-010	0229187
	CAP ASSY. A, NOISE SUPPRESSOR		K	K1	6						2		30700-405-153	0482711
	CAP ASSY. A, NOISE SUPPRESSOR		K	K1	6						2		30700-405-163	3528221
13	CAP ASSY. C, NOISE SUPPRESSOR		K	K1	6						2		30701-323-013	0254292
					6					1241400	2		30701-323-013	0254292
	CAP ASSY., NOISE SUPPRESSOR		K	K1	6						2		30700-MC8-000	1234616
					6					1241400	2		30700-MC8-000	1234616
	CAP ASSY. C, NOISE SUPPRESSOR		K	K1	6						2		30700-390-153	0488015
					6					1241400	2		30700-390-153	0488015
	CAP ASSY. C, NOISE SUPPRESSOR		K	K1	6						2		30700-390-163	3819133
					6					1241400	2		30700-390-163	3819133
	CAP ASSY. C, NOISE SUPPRESSOR		K	K1	6						2		30701-323-023	0447474
					6					1241400	2		30701-323-023	0447474
14	REGULATOR ASSY. (HITACHI)		K	K1	6						1		31400-300-035	0191817
15	RUBBER, REGULATOR CUSHION		K	K1	6						1		31403-323-000	0254300
16	BATTERY ASSY. (12V12A)		K	K1	6						1		31500-310-671	0113142
	BATTERY ASSY.		K	K1	6						1		98203-22250	0430462

AMERICAN HONDA MOTOR CO., LTD. 1984 119

## CONTENTS

TITLE	PAGE	GRID
AIR CLEANER	78	E3
ALTERNATOR	24	B12
BOLT	48	C12
BRAKE MASTER FR	132	G6
CABLE	50	D1
CAMSHAFT	10	B5
CARBURETOR	44	C10
CLUTCH	16	B8
CRANKCASE	40	C8
CRANKCASE COVER	16	B8
CRANKSHAFT	10	B5
CYLINDER	2	B1
CYLINDER	132	G6
EXHAUST MUFFLER	90	E9
FENDER FR	62	D7
FRAME	118	F11
FUEL TANK	78	E3
HANDLEBAR	50	D1
HEAD	2	B1
HEADLIGHT	36	D4
KICK STARTER SPINDLE	30	C3
OIL FILTER	40	C8
OIL PUMP	24	B12
SHOCK ABSORBER FR	98	F1
SPEEDOMETER	56	D4
STEERING STEM	62	D7
STEP	90	E9
SWINGARM	98	F1
TACHOMETER	56	D4
TAILLIGHT K	106	F5
TAILLIGHT K1-76	112	F8
TRANSMISSION	100	C3
TURN SIGNAL K	100	F5
TURN SIGNAL K1-76	112	F8
WASHER (CRANKCASE)	48	C12
WHEEL FR	70	D11
WHEEL RR	70	D11
WIRE HARNESS	118	F11

GRID

F11

# FRAME • WIRE HARNESS

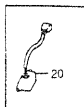
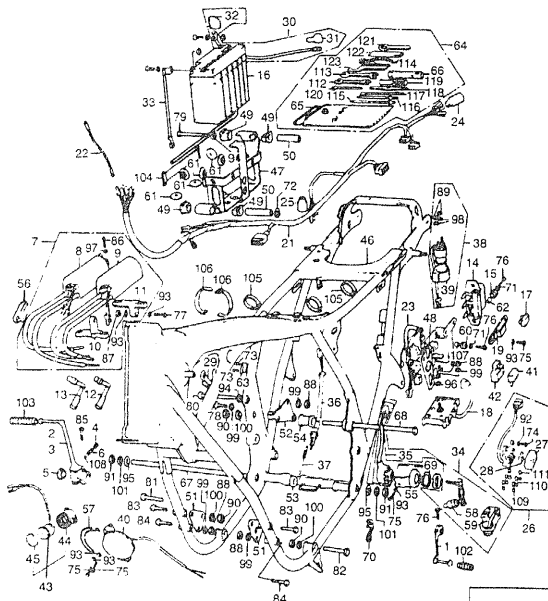

"CAUTION OR WARNING LABELS MUST BE ORDERED SEPARATELY WHEN APPLICABLE"

F13374009

K = CB550  
K1 = CB550K1  
6 = CB550K76

Part No.	BLOCK NO. DESCRIPTION	F-9	K	K1	6	CB550	K	K1	6	FRAME SERIAL NUMBER FROM TO	QTY REQ	PART NUMBER	HONDA CODE
17	RECTIFIER ASSY., SILICON (STANLEY) .....				6						1	31700-124-003	0351346
	RECTIFIER ASSY., SILICON (SHINDENGO) .....				6						1	31700-124-008	0692129
18	RECTIFIER ASSY. ....		K	K1	6						1	31700-323-015	0291633
	RECTIFIER ASSY. ....		K	K1	6						1	31700-333-008	0297341
19	STAY, DIODE .....				6						1	31706-341-900	0435131
20	SAFETY UNIT, STARTING .....		K	K1							1	31800-341-701	0314617
21	HARNES, WIRE .....		K	K1							1	32100-374-000	0362525
	HARNES, WIRE .....				6						1	32100-374-700	0434928
22	CABLE A, SUB .....				6						1	32101-385-000	0426304
23	HARNES, SUB WIRE .....		K	K1							1	32105-374-670	0362533
	HARNES, SUB WIRE .....				6						1	32105-374-700	0434936
24	COVER, CABLE HARNES CONNECTOR ..		K	K1	6						1	32108-046-750	0258178
25	COVER, CABLE HARNES CONNECTOR ..		K	K1	6						1	32108-323-300	0258186
26	BOX ASSY., FUSE .....		K	K1	6						1	32110-341-702	0476598
27	COVER, FUSE BOX .....		K	K1	6						1	32117-341-702	0314658
28	FUSE, GROMMET .....		K	K1	6						1	32118-341-702	0314666
29	CLIP, CABLE HARNES .....		K	K1	6						1	32171-323-000	0254359
30	CABLE, STARTER BATTERY .....		K	K1	6						1	32401-323-000	0254367
31	COVER, STARTING MOTOR TERMINAL ..		K	K1	6						1	32411-230-000	0208652
	COVER, STARTING MOTOR TERMINAL ..		K	K1	6						1	32411-253-000	0177360
32	COVER, BATTERY TERMINAL .....		K	K1	6						1	32412-323-000	0254375
33	CABLE, BATTERY GROUND .....		K	K1	6						1	32601-323-000	0254383
34	SWITCH KIT, MAIN .....		K								1	35010-341-702	0688101
	KEY SET .....		K								1	35011-369-740	0382523
	SWITCH KIT, MAIN .....		K								1	35020-323-672	0291625
	SWITCH KIT, MAIN .....		K								1	35020-341-700	0314799
	SWITCH SET, COMBINATION .....		K								1	35020-341-701	0387951
	KEY SET .....		K	K1	6						1	35010-374-670	0387746
	SWITCH KIT, MAIN .....		K	K1	6						1	35020-374-671	0675309
35	SWITCH ASSY., COMBINATION (TOYO) ..		K								1	35100-323-003	0325464
	SWITCH ASSY., COMBINATION .....		K								1	35100-369-740	0447334

## CONTENTS

TITLE	PAGE	GRID
AIR CLEANER	76	E2
ALTERNATOR	24	R2
BOLT	48	C12
BRAKE MASTER FR	132	G6
CABLE	50	D1
CAMSHAFT	10	B5
CARBURETOR	44	C10
CLUTCH	16	B8
CRANKCASE	40	C3
CRANKCASE COVER	16	B9
CRANKSHAFT	10	B5
CYLINDER	2	B1
CYLINDER	132	G6
EXHAUST MUFFLER	90	F4
FENDER FR	62	D7
FRAME	118	F11
FUEL TANK	78	D1
HANDLEBAR	56	D1
HEAD	2	B1
HEADLIGHT	56	D4
KICK STARTER SPINDLE	20	C2
OIL FILTER	40	C8
OIL PUMP	24	B2
SHOCK ABSORBER RH	95	F1
SPEEDOMETER	55	D4
STEERING STEM	42	D7
STEP	90	F9
SWINGARM	88	F1
TACHOMETER	56	D4
TAILLIGHT K	106	F5
TAILLIGHT K1-76	112	F8
TRANSMISSION	30	C2
TURN SIGNAL K	106	F5
TURN SIGNAL K1-76	112	F8
WASHER (CRANKCASE)	48	C12
WHEEL FR	70	D11
WHEEL RR	70	D11
WIRE HARNESS	118	F11

GRID

F12

# FRAME • WIRE HARNESS

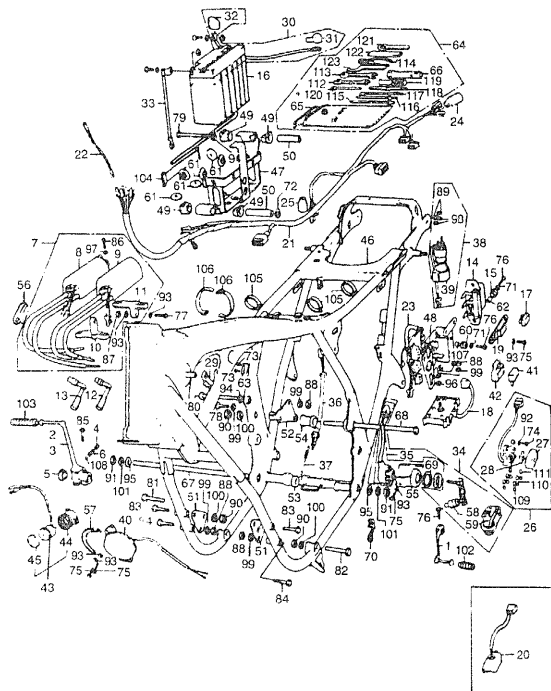

"CAUTION OR WARNING LABELS MUST BE ORDERED SEPARATELY WHEN APPLICABLE"

F13374009

K = CB550  
K1 = CB550K1  
F = CB550K76

Ref. No.	BLOCK NO. DESCRIPTION	F-9	CB550			FRAME SERIAL NUMBER FROM TO	QTY	PART NUMBER	HONDA CODE
			K	K1	6				
35	SWITCH ASSY., COMBINATION .....		K	K1	6	-----	1	35100-374-000	0387753
	SWITCH ASSY., COMBINATION (TOYO) .....		K	K1	6	-----	1	35100-374-007	0497032
36	SWITCH ASSY., RR. STOP .....		K	K1	6	-----	1	35350-K19-405	3780665
	SWITCH ASSY., STOP (TOYO) .....		K	K1	6	-----	1	35350-292-003	0143883
	SWITCH ASSY., STOP .....		K	K1	6	-----	1	35350-336-000	0268623
37	SPRING, STOP SWITCH .....		K	K1	6	-----	1	35357-011-000	0008458
38	SWITCH ASSY., STARTER MAGNETIC ..		K	K1	6	-----	1	35850-306-670	0191908
	SWITCH ASSY., STARTER MAGNETIC ..		K	K1	6	-----	1	35850-371-670	0406207
39	SUSPENSION, MAGNETIC SWITCH .....		K	K1	6	-----	1	35856-323-000	0254098
40	HORN ASSY. (MITSUBA) .....		K	K1	6	-----	1	38100-300-023	0201954
41	FLASHER, (142 12V) .....		K	K1	6	-----	1	38300-292-670	0146555
	RELAY ASSY., TURN SIGNAL .....		K	K1	6	-----	1	38301-K16-741	1596915
	RELAY COMP., TURN SIGNAL (MITSUBA) .....		K	K1	6	-----	1	38301-K16-742	1717953
	RELAY COMP., TURN SIGNAL (MITSUBA) .....		K	K1	6	-----	1	38301-K16-743	2957611
42	SUSPENSION, TURN SIGNAL RELAY ..		K	K1	6	-----	1	38306-107-670	0217604
43	BUZZER ASSY., TURN SIGNAL .....		K	K1	6	-----	1	38400-341-674	0314880
44	COVER, BUZZER .....		K	K1	3	-----	1	38402-341-671	0273615
45	PLATE, TURN SIGNAL BUZZER .....		K	K1	6	-----	1	38403-341-672	0273623
46	FRAME COMP. *NH1* (BLACK) .....		K	K1	6	-----	1	50100-323-674B	0291666
47	BOX, BATTERY .....		K	K1	6	-----	1	50100-374-7102A	0434951
48	PLATE, ELECTRIC BASE .....		K	K1	6	-----	1	50325-323-040	0253930
49	RUBBER, BATTERY BOX .....		K	K1	6	-----	1	50330-374-000	0362657
50	COLLAR, BATTERY BOX .....		K	K1	6	-----	4	50331-323-000	0253955
51	BRACKET, FR. ENGINE HANGER .....		K	K1	6	-----	2	50332-323-000	0253963
52	BRACKET, RR. ENGINE HANGER .....		K	K1	6	-----	2	50351-323-010B	0253971
	BRACKET, RR. ENGINE HANGER .....		K	K1	6	-----	1	50356-374-000	0362665
	BRACKET, RR. ENGINE HANGER .....		K	K1	6	-----	1	50356-374-010	0390864
	BRACKET, RR. ENGINE HANGER .....		K	K1	6	-----	1	50356-374-010	0390864
53	COLLAR, R. ENGINE LOWER SIDER ....		K	K1	6	-----	1	50357-323-010	0253997
54	COLLAR, L. ENGINE UPPER .....		K	K1	6	-----	1	50359-323-010	0254003
55	BRACKET, MAIN SWITCH .....		K	K1	6	-----	1	50375-323-020	0254011

## CONTENTS

TITLE	PAGE	GRID
AIR CLEANER	7H	E3
ALTERNATOR	24	B12
BOLT	48	C12
BRAKE MASTER FR	132	G5
CABLE	50	D*
CAMSHAFT	10	B5
CARBURETOR	44	C10
CLUTCH	16	B8
CRANKCASE	40	C5
CRANKCASE COVER	16	B9
CRANKSHAFT	10	B5
CYLINDER	2	B1
CYLINDER	132	G6
EXHAUST MUFFLER	90	E5
FENDER FR	62	D*
FRAME	118	H11
FUEL TANK	78	E3
HANDLEBAR	50	D1
HEAD	2	B1
HEADLIGHT	56	D4
KICK STARTER SPINDLE	30	C3
OIL FILTER	40	C8
OIL PUMP	24	B12
SHOCK ABSORBER FR	98	F1
SPEEDOMETER	56	D4
STEERING STEM	62	D7
STEP	90	E9
SWINGARM	98	F1
TACHOMETER	56	D4
TAILLIGHT K	106	F5
TAILLIGHT K1-76	112	F8
TRANSMISSION	30	C3
TURN SIGNAL K	106	F5
TURN SIGNAL K1-76	112	F8
WASHER (CRANKCASE)	48	C12
WHEEL FR	70	D11
WHEEL RR	70	D11
WIRE HARNESS	118	F11

GRID

G1

CB550 ENGINE NO.; CB550E-1000001 TO SUBSEQUENT  
CB550 FRAME NO.; CB550K-1000001 TO SUBSEQUENT  
CB550K1 ENGINE NO.; CB550E-1029182 TO SUBSEQUENT  
CB550-1 FRAME NO.; CB550K-1200001 TO SUBSEQUENT

CB550K76 ENGINE NO.; CB550E-1067334 TO SUBSEQUENT  
CB550K76 FRAME NO.; CB550K-1230001 TO SUBSEQUENT

# FRAME • WIRE HARNESS

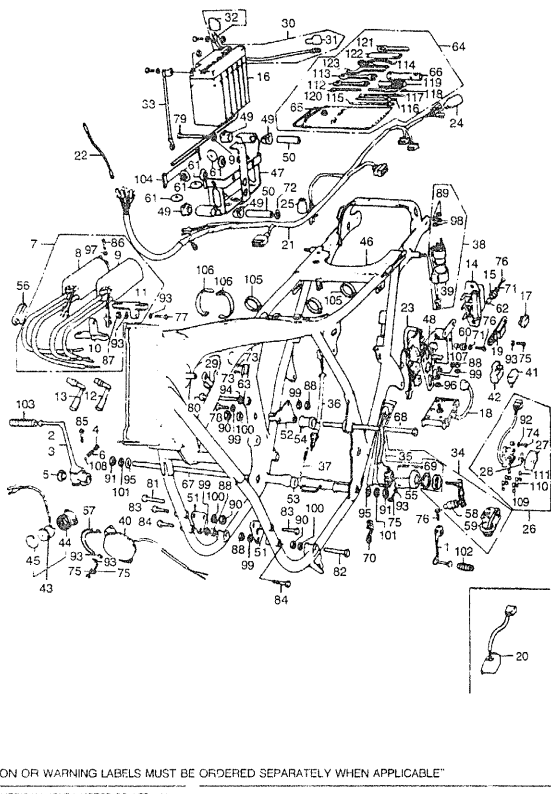

"CAUTION OR WARNING LABELS MUST BE ORDERED SEPARATELY WHEN APPLICABLE"

F133/4009

K = CB550  
K1 = CB550K1  
6 = CB550K76

K = CB550 K1 = CB550K1 6 = CB550K76			CB550	C B 5 5 0 K 7 6	FRAME SERIAL NUMBER		Q T Y			
Rel No.	BLOCK NO. DESCRIPTION	F-9	K	K1	6	FROM	TO	R E Q	PART NUMBER	HONDA CODE
56	PROTECTOR, IGNITION COIL WIRE ...		K	K1	6	-----	-----	1	50400-323-000	0254029
57	CLAMP, TACHOMETER CABLE .....		K	K1	6	-----	-----	1	50462-323-000	0254037
	CLAMP, TACHOMETER CABLE .....		K	K1	6	-----	-----	1	50462-323-010	0469080
58	LOCK COMP., HANDLEBAR .....		K	K1	6	-----	-----	1	35010-230-010	0136168
	LOCK COMP., HANDLEBAR (TOYO) .....		K	K1	6	-----	-----	1	53600-230-000	0137844
59	LOCK ASSY., SEAT (HONDA LOCK) ...		K	K1	6	-----	-----	1	77230-107-711	0334649
	LOCK ASSY., SEAT (TOYO) .....		K	K1	6	-----	-----	1	77230-347-003	0291450
60	RUBBER A, RR. FENDER .....		K	K1	6	-----	-----	2	80105-061-000	0186627
61	RUBBER, BATTERY BOX .....		K	K1	6	-----	-----	6	83618-323-000	0255810
62	COLLAR, NUMBER BRACKET SETTING ..		K	K1	6	-----	-----	2	84706-286-000	0166462
63	MARK, BATTERY CAUTION .....		K	K1	6	-----	-----	1	87506-374-670	0362822
64	TOOL SET .....		K	K1	6	-----	-----	1	89010-323-010	0313148
	TOOL SET .....		K	K1	6	-----	-----	1	89010-390-000	0433268
65	BAG, TOOL .....		K	--	--	1022272	-----	1	89101-ME5-670	1669480
	BAG, TOOL .....		K	K1	6	-----	-----	1	89101-ME5-670	1669480
	BAG, TOOL .....		K	--	--	1022272	-----	1	89101-300-010	0192369
	BAG, TOOL, 200MM .....		K	--	--	1022272	-----	1	89101-300-010	0192369
	BAG, TOOL, 200MM .....		K	K1	6	-----	-----	1	89101-300-010	0192369
66	WRENCH, SPARK PLUG .....		K	K1	6	-----	-----	1	89216-323-000	0254094
67	BOLT, RR. ENGINE HANGER LOWER .....		K	K1	6	-----	-----	1	90107-323-000	0254136
68	BOLT, RR. ENGINE UPPER .....		K	K1	6	-----	-----	1	90108-323-000	0254144
69	WASHER, 25X33 (TOYO) .....		--	K1	6	-----	-----	1	90501-374-003	0387886
70	GUIDE, BREATHER .....		--	6	6	-----	-----	1	90514-374-700	0435024
71	WASHER, 18MM .....		K	K1	6	-----	-----	4	90581-701-000	0173823
	WASHER, 18MM .....		K	K1	6	-----	-----	4	90581-831-650	0166454
72	WASHER, 8MM .....		K	K1	6	-----	-----	1	90582-703-000	0254219
73	SCREW, RIVET, 1.5X5 .....		K	K1	6	-----	-----	2	90841-001-000	0172866
74	BOLT, HEX., 5X14 .....		K	K1	6	-----	-----	2	92000-05014-0A	0207381
75	BOLT, HEX., 6X12 .....		K	K1	6	-----	-----	5	92000-06012	0054197
	BOLT, HEX., 6X12 .....		K	K1	6	-----	-----	5	92101-06012	2738821
	BOLT, HEX., 6X12 .....		K	K1	6	-----	-----	5	92101-06012-0A	3591500
76	BOLT, HEX., 6X20 .....		K	K1	6	-----	-----	5	92000-06020	0054270
	BOLT, HEX., 6X20 .....		K	K1	6	-----	-----	5	92101-06020-0A	2528925

## CONTENTS

TITLE	PAGE	GRID
AIR CLEANER	76 E3	
ALTERNATOR	24 B12	
BOLT	48 C12	
BRAKE MASTER FR	130 G6	
CABLE	50 D1	
CAMSHAFT	10 B5	
CARBURETOR	44 C10	
CLUTCH	16 B8	
CRANKCASE	40 C8	
CRANKCASE COVER	16 B5	
CRANKSHAFT	16 B5	
CYLINDER	2 B1	
CYLINDER	130 G6	
EXHAUST MUFFLER	90 E9	
FENDER, FR.	62 D7	
FRAME	118 F11	
FUEL TANK	76 E3	
HANDLEBAR	50 D1	
HEAD	2 B1	
HEADLIGHT	56 D4	
KICK STARTER SPINDLE	30 C3	
OIL FILTER	40 C8	
OIL PUMP	24 B12	
SHOCK ABSORBER, FR	98 F1	
SPEEDOMETER	56 D4	
STEERING STEM	62 D7	
STEP	90 E9	
SWINGARM	98 F1	
TACHOMETER	56 D4	
TAILLIGHT K	106 F5	
TAILLIGHT K-76	112 F8	
TRANSMISSION	30 C3	
TURN SIGNAL K	106 F5	
TURN SIGNAL K-76	112 F8	
WASHER (CRANKCASE)	48 C12	
WHEEL, FR	70 D11	
WHEEL, RR	70 D11	
WIRE HARNESS	118 F11	

GRID

G2



# FRAME • WIRE HARNESS

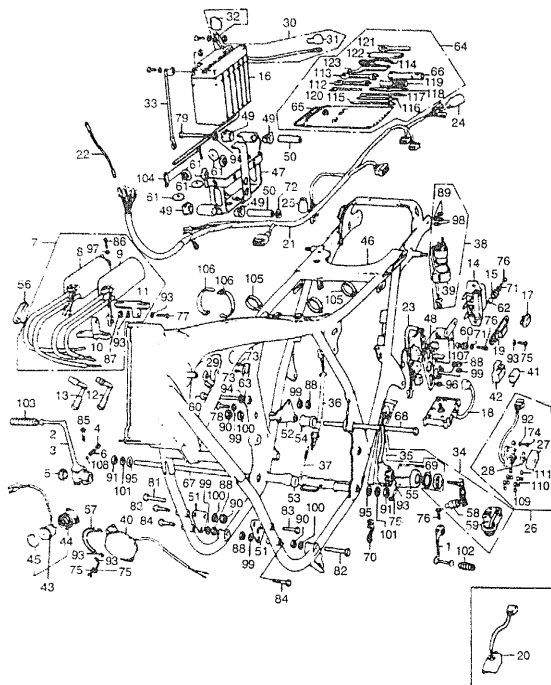

"CAUTION OR WARNING LABELS MUST BE ORDERED SEPARATELY WHEN APPLICABLE"

F 13374009

K = CB550  
K1 = CB550K1  
6 = CB550K76

Ref. No.	BLOCK NO DESCRIPTION	F-9	CB550			QTY REQ	PART NUMBER	HONDA CODE
			K	K1	6			
			FRAME SERIAL NUMBER					
						FROM TO		
77	BOLT, HEX., 6X25 .....		K	K1	6	2	92000-06025	0054320
	BOLT, HEX., 6X25 .....		K	K1	6	2	92101-06025-0A	2206563
78	BOLT, HEX., 8X40 .....		K	K1	6	1	92000-08040-0A	0192781
	BOLT, HEX., 8X40 .....		K	K1	6	1	92101-08040-0A	3839321
79	BOLT, HEX., 8X65 .....		K	K1	6	1	92000-08065-0A	0256834
80	BOLT, HEX., 8X100 .....		K	K1	6	1	92000-08100-0A	0256859
	BOLT, HEX., 8X100 .....		K	K1	6	1	92101-08100-0A	3391497
81	BOLT, HEX., 10X50 .....		K	K1	6	2	92200-10050-0A	0193003
82	BOLT, HEX., 10X80 .....		K	K1	6	2	92200-10080-0A	0193011
83	BOLT, HEX., 8X50 .....		K	K1	6	2	93000-08050-0A	0258244
84	BOLT, HEX., 8X55 .....		K	K1	6	2	93000-08055-0A	0258251
85	BOLT, HEX., 8X32 .....		K	K1	6	1	93200-08032-0A	0258020
86	SCREW, PAN, 5X20 .....		K	K1	6	4	93500-05020-0A	0197731
87	NUT, HEX., 6MM .....		K	K1	--	2	90310-KA3-711	1553916
	NUT, HEX., 6MM .....		K	K1	--	2	94000-06000-0S	1391283
	NUT, HEX., 6MM .....		K	K1	--	2	94001-06000	0058016
	NUT, HEX., 6MM .....		K	K1	--	2	94001-06000-3S	0156067
	NUT, HEX., 6MM .....		K	K1	--	2	94001-06008-0S	2829414
	NUT, HEX., 6MM .....		K	K1	--	2	94001-06200-0S	2043255
	NUT, HEX., 6MM .....		K	K1	--	2	94030-06000	1642693
	NUT, FLANGE, 6MM .....		--	--	6	2	18362-720-000	0293084
	NUT, FLANGE, 6MM .....		--	--	6	2	94050-06000	0471623
88	NUT, HEX., 8MM .....		K	K1	6	5	94001-08000-0S	0167338
89	NUT, HEX., 6MM .....		K	K1	6	2	94002-06000-0S	0181032
90	NUT, HEX., 10MM .....		K	K1	6	5	94030-10000	0223024
91	NUT, HEX., 12MM .....		K	K1	6	2	94030-12000	0217505
92	WASHER, PLAIN, 5MM .....		K	K1	6	2	94101-05000	0059055
93	WASHER, PLAIN, 6MM .....		K	K1	--	7	94101-06000	0059071
	WASHER, PLAIN, 6MM .....		--	--	6	5	94101-06000	0059071
	WASHER, PLAIN, 6MM .....		K	K1	--	7	94101-06080	3136074
	WASHER, PLAIN, 6MM .....		--	--	6	5	94101-06080	3136074
	WASHER, PLAIN, 6MM .....		K	K1	--	7	94101-06800	0345900
	WASHER, PLAIN, 6MM .....		--	--	6	5	94101-06800	0345900

## CONTENTS

TITLE	PAGE	GRID
AIR CLEANER	76	E1
ALTERNATOR	24	B12
BOLT	48	C12
BRAKE MASTER FR	136	O6
CABLE	50	D1
CAMSHAFT	10	U5
CARBURETOR	44	C10
CLUTCH	16	B9
CRANKCASE COVER	49	C8
CRANKSHAFT	16	B8
CYLINDER	2	B1
CYLINDER	132	G6
EXHAUST MUFFLER	90	E9
FENDER FR	62	D7
FRAME	118	F11
FUEL TANK	76	E3
HANDLEBAR	50	D1
HEAD	2	B1
HEADLIGHT	56	D4
KICK STARTER SPINDLE	39	C3
OIL FILTER	40	C8
OIL PUMP	24	B12
SHOCK ABSORBER FR	98	F1
SPEEDOMETER	56	D4
STEERING STEM	62	D7
STEP	90	E9
SWINGARM	98	F1
TACHOMETER	56	D4
TAILLIGHT K	106	F7
TAILLIGHT K1-76	112	F7
TRANSMISSION	30	C3
TURN SIGNAL K	106	F5
TURN SIGNAL K1-76	112	F8
WASHER (CRANKCASE)	48	C12
WHEEL FR	70	D11
WIRE HARNESS	118	F11

GRID

G3